

## Oil Injection Crankcase Pressure Valve – 135 thru 275

### Mariner and Mercury

135-200 S/N OD067952 and above

275 S/N OD070440 XL and above  
S/N OD078274 CXL and above  
S/N OD078285 XXL and above

There has been a product improvement to the crankcase pressure valve P/N 21-43278. The valves used before the serial number listed above had 0.0135 in. (0.34mm) pressure relief hole in the center of disc in the inner check valve. The new valve will have the hole moved to the side of the inner check valve to lessen the possibility of blockage and ease of manufacturing.

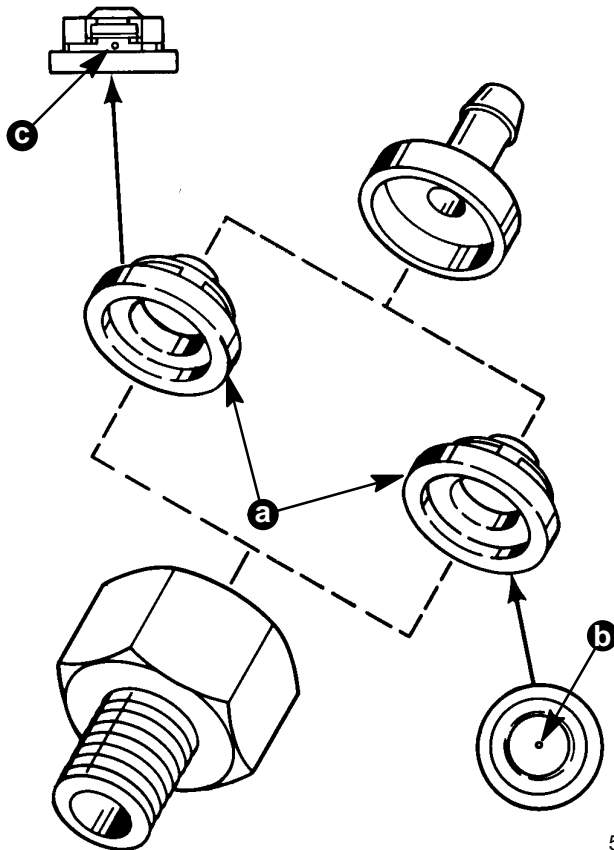

51379

- a - Inner Check Valve
- b - Previous Pressure Relief Hole
- c - New Pressure Relief Hole

### SERVICE TIP:

When inspecting the previous style check valve, the pressure relief hole can be seen from either end. The new valve does not have an external hole that can be seen. To determine that the pressure relief hole is open on the new valve, slowly loosen the filler cap on remote oil tank one minute after engine shut down. There should not be any pressure released.

### QUICKSILVER:

Replacement valves P/N 21-43278 ordered from parts distribution centers, will be the previous style until current stock is depleted. Part number will not change.