

Shift Interrupt Diode Replacement Kit P/N 17461A5 - 225

Mariner/Mercury
1994 225
S/N 0D280813 thru 0G129221
Shift Interrupt Diode Kit P/N 17461A5

A Shift Interrupt Diode Kit P/N 17461A5 has been designed to replace a failed shift interrupt diode without replacing the main engine harness.

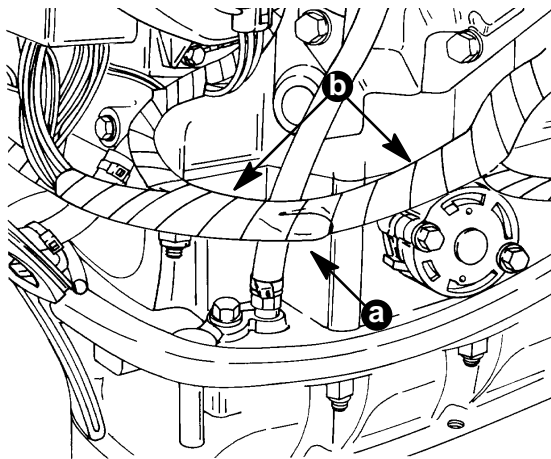

53276

a - Diode Location
 b - Electrical Tape

Figure 1. Shift Interrupt Diode Location.

The diode in the main engine harness, allows the shift interrupt switch to shut off ignition on cylinders 2, 4, and 6 (port side CDMs) when shifting in and out of gear. It also allows all cylinders to be shut off with the key switch.

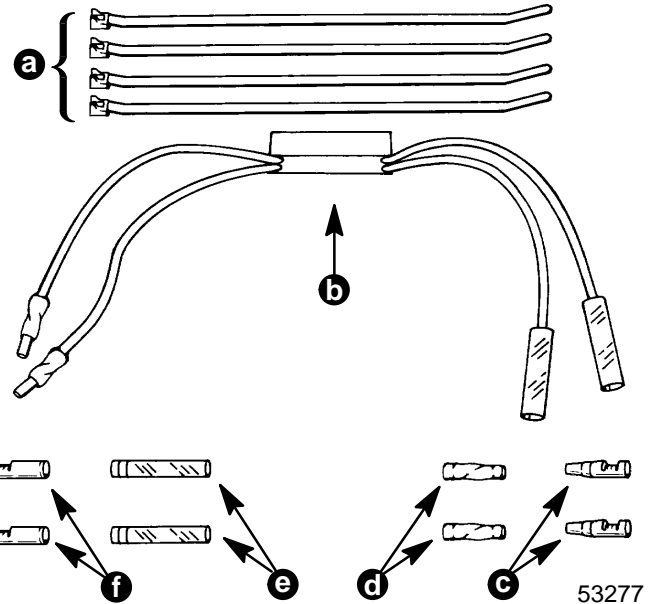

CONTENTS OF KIT:

	Qty.	P/N	Description
a.	4	69355	Cable Tie
b.	1	NSS	Shift Diode Module
c.	2	84-814434	Terminal-Male
d.	2	85-17198	Insulator-Male
e.	2	85-17199	Insulator-Female
f.	2	86-814433	Terminal-Female
	1	90-827642	Installation Instructions

SYMPTOM:

If the diode is faulty, it will fail in either an open or closed circuit.

Open Circuit - will not allow the engine to be shut off with the key switch on cylinders 2, 4, and 6 (port side CDMs).

Closed Circuit - will cause the shift interrupt switch to shut off all cylinders each time the motor is shifted in or out of gear. Generally, the engine will stop when shifted.

TESTING:

A diode allows current to flow in only one direction and can be easily tested using an Ohm meter. Use the R X 1K scale.

1. Connect one meter lead to the black/yellow wire at the shift interrupt switch connector of the main engine harness (refer to diagram on the last page).
2. Connect the other meter lead to the black/yellow wire (Terminal 1) of the main engine harness connector. The meter should measure continuity or no continuity.
3. Reverse the meter leads.

The second reading should be opposite of the first reading, and indicates the diode is good. If the readings are the same both ways, the diode is faulty and needs to be replaced with this kit.

REPAIR:

The replacement kit consists of a diode module that will be installed in place of the failed diode in the main engine harness and will remain external from the harness.

TOOL RECOMMENDATION:

91-808696 Terminal Crimping Tool

WARRANTY:

If the failure occurs within twelve months from the date of sale, the normal warranty applies.

Complete warranty claim listing:

Outboard serial number

Qty. 1 P/N 17461A5 Shift Interrupt Diode Kit.

Eight tenths (0.8) hour labor.

Warranty labor rate code NJC.

Failure code 331 00.

US & Canada - return the defective shift diode with the claim.

International - Hold parts for inspection/disposal by a Marine Power International technical representative.

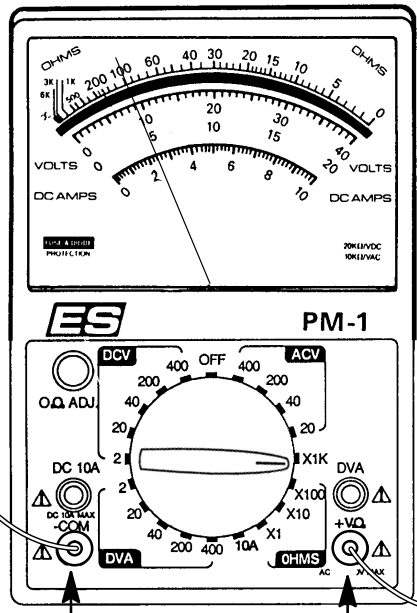
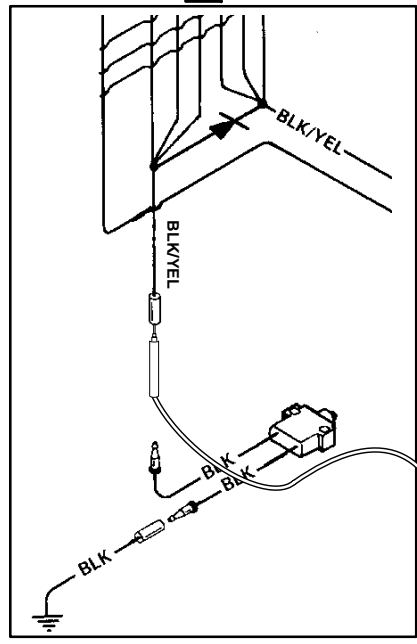
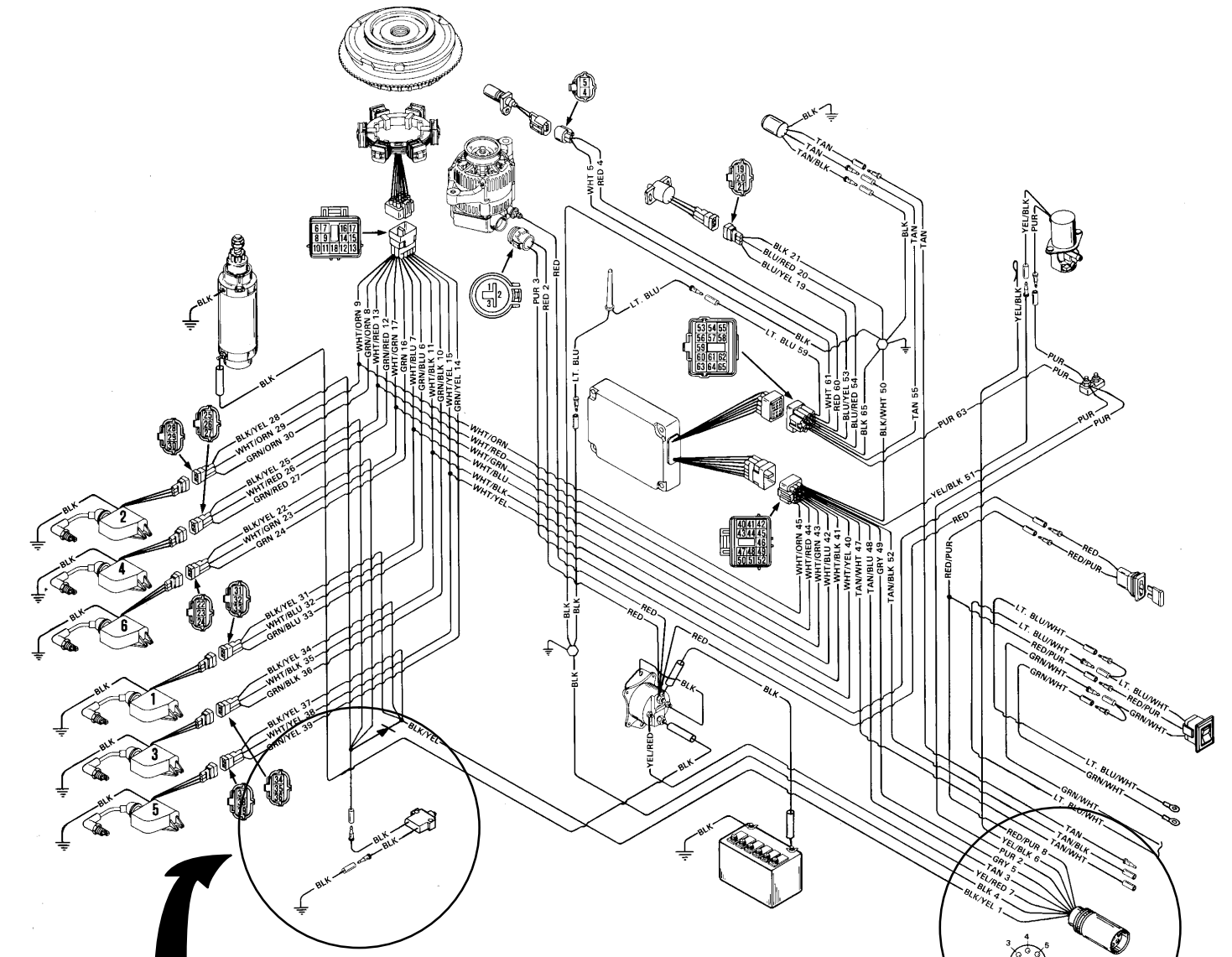

BLACK METER LEAD

RED METER LEAD

