



service bulletin

No. 98-23

Check Valve Kit – 135/150 Optimax

Models Affected

MERCURY/MARINER
135/150 HP Optimax
S/N 0G636539 Thru 0G886266

Check valves have been added to the crankcase oil delivery hoses to prevent evacuation of oil from the hoses under certain running conditions, and improve oil delivery to the engine. This product improvement is being offered to current owners and on outboards in dealer inventory to provide improved reliability, and durability. The check valves have been installed on production outboards as a running change beginning with serial number 0G886267. Check valves used in production will be incorporated into the oil hose fitting pressed in the cylinder block, and not an inline check valve as offered in this bulletin.

OWNER NOTIFICATION - USA/CANADA

A letter will be sent to every registered owner of an affected outboard. The letter will advise the owner to return their outboard to their selling dealer or any Mercury/Mariner authorized dealer for the update.

DEALER OUTBOARD INVENTORY

Affected outboards in dealer inventory MUST BE updated prior to customer delivery.

CORRECTION

Install check valve kit **P/N 21-858945A2** on engines in the above serial number range. Kit will include 6 check valve/hose assemblies, 12 sta-straps, and installation instructions. Because two different hose diameters were used on production engines, care must be taken to install check valves on the correct cylinders. Check valves with the 3.125 in. (79.4 mm) hose and BLUE strip/band are to be installed on the starboard side. Check valves with the 1.250 in. (31.7 mm) hose and brass colored are installed on the port side.

NOTE: Before proceeding with the check valve up-date confirm that the work has not been completed prior to receiving the engine. Look for the WHITE paint dot repair identification on the alternator bracket, presence of the check valves, or refer to the Midas system under engine history.

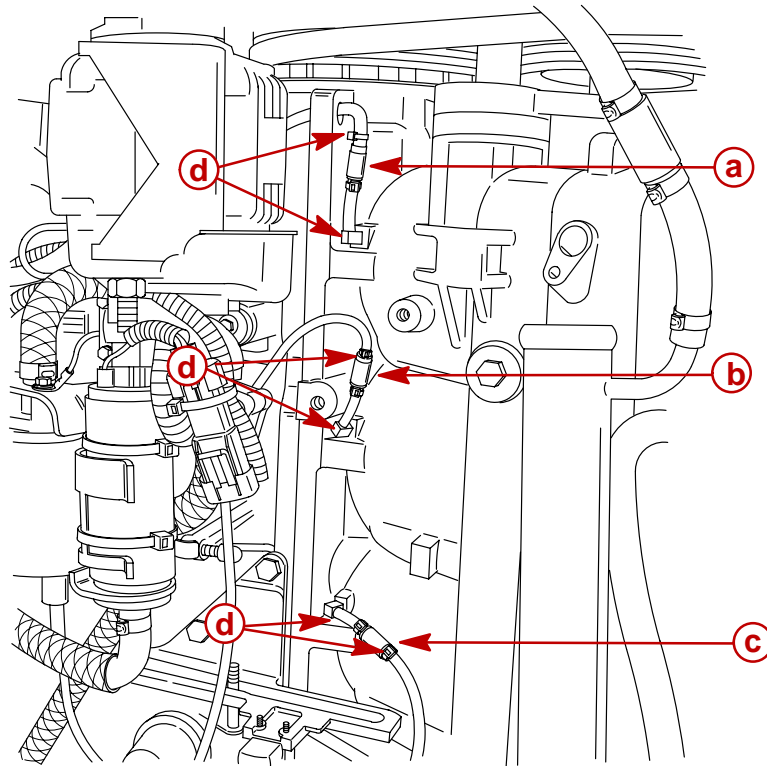

57410

Check Valve Location - Port Side

- a** - #2 Cylinder Oil Hose [Trim hose length as required]
- b** - #4 Check Valve/Hose Assembly
- c** - #6 Check Valve/Hose Assembly
- d** - Sta-Straps

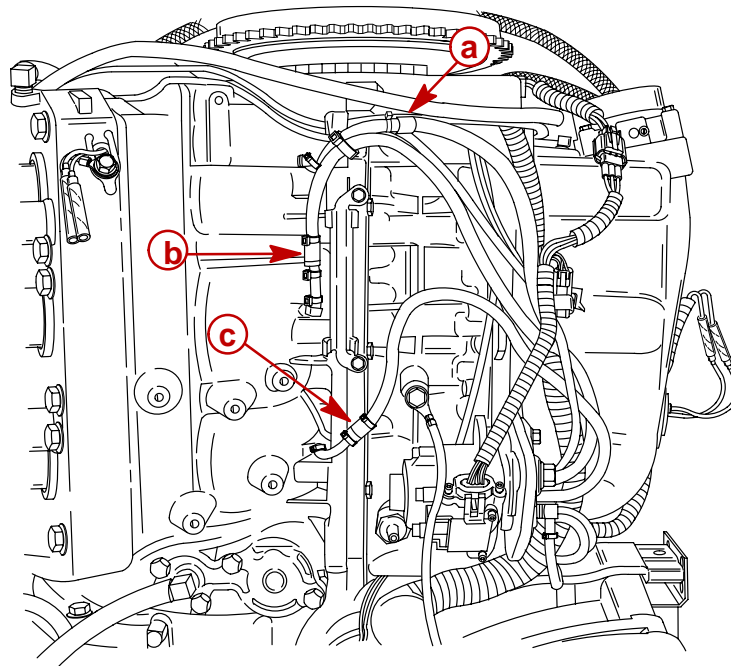

57411

Check Valve Location - Starboard Side

- a** - #1 Check Valve/Hose Assembly
- b** - #3 Check Valve/Hose Assembly
- c** - #5 Check Valve/Hose Assembly

PARTS REQUIRED

Qty. 1 Check valve kit **P/N 21-858945A2**

REPAIR IDENTIFICATION

After the check valve kit has been installed, place a **WHITE** paint dot on the front alternator bracket.

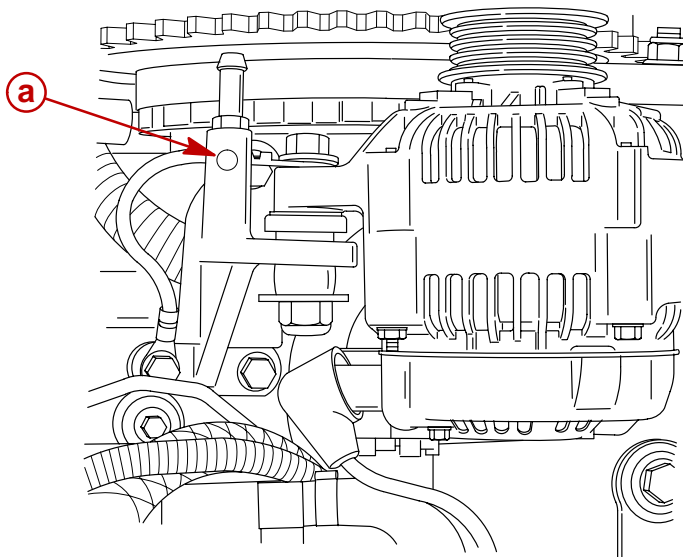

57286

a - Repair Identification (WHITE paint dot)

WARRANTY

The normal (3 year 1998 model) or (2 year 1999 model) Optimax warranty applies. Complete warranty claim listing:

- Outboard serial number
- Qty. 1 Check valve kit P/N 21-858945A2
- One and 1/2 (1.5) hours labor
- Flat rate code NJC
- Failure code 746-00

US & Canada - Complete/process claim via Midas or return a warranty claim form.

INTERNATIONAL: Follow instructions issued by Marine Power International office or by your distributor.



Mercury Marine

Marine Products and Services

W6250 Pioneer Road
P.O. Box 1939
Fond du Lac, WI 54936-1939 USA
Phone: 920-929-5000
www.mercurymarine.com

Dear Mercury Marine Customer:

Our records indicate that you are the owner of a Mercury Marine outboard included in a recall. Check valves have been added to the crankcase oil delivery hoses to prevent evacuation of oil from the hoses under certain running conditions, and improve oil delivery to the engine. This product improvement is being offered to current owners to provide improved liability and durability.

WHAT YOU SHOULD DO

Contact your authorized dealer, preferably the one who sold you the engine, and make arrangements to determine if your engine needs to be up-dated. The dealer will refer to Mercury Marine Service Bulletin 98-23 for instructions. You must deliver your engine to the dealer and present this letter, the reverse side of which is a claim-form your dealer needs to send to us for reimbursement.

NOTE: If your boat is in storage, you may want to wait until you remove it from storage to have this service performed.

WHAT WE WILL DO

We will reimburse the authorized dealer for installing the check valve kit in accordance with the Service Bulletin 98-23.

We apologize for any inconvenience this recall may have caused you. However, we have taken this action to assure your boating enjoyment and continued satisfaction with our product.

Sincerely,

Technical Service