



Service Bulletin

Bulletin No. 2006-13
OEM No. 2006-09

Circulate to: Sales Manager Accounting Service Manager Technician Parts Manager

Official Recall Notification Federal Boat Safety Act Commander 3000 Remote Control

NOTICE		
This Bulletin supersedes Mercury/Mariner Outboard Service Bulletin 1996-13 and OEM Bulletin 1996-03.		

Commander 3000 Remote Controls		
88150A40	827270A6	88688H52
88150A42	827270A9	88688A57
88150A45	88688A40	88150A41
88150A50	88688A44	88150A43
827270A2	88688A50	88150A47
88150A51	827270A3	827270A7
827270A10	88688A42	88688A46
88688A51	88688A54	88688A58
88150H41	88150A44	88150A48
827270A1	827270A5	827270A8
827270A11	88688H42	88688A48
88688A52	88688A56	

Situation

Commander 3000 remote controls built between June 1, 1994 and September 1, 1995 could fail; resulting in the inability to reduce throttle, and shift the engine out of gear. This failure is caused by an improperly hardened gear in the control mechanism. The Gen I Commander 3000 Remote Control is No Longer Available (NLA). This Service Bulletin reflects the use of the Gen II Remote Control as a replacement part, along with the Gen II Throttle and Shift Cables.

THE INFORMATION IN THIS DOCUMENT IS CONFIDENTIAL AND PROTECTED BY COPYRIGHT AND IS THE PROPERTY OF MERCURY MARINE.

This document is provided for the sole and exclusive use of the original recipient as prescribed by Mercury Marine and may not be distributed or copied, digitally or otherwise, without the prior written consent of Mercury Marine.

Commander 3000 Control Identification

1. **Determine if you have a Commander 3000 control.** If the control in your boat does not match any of the controls pictured below, you do not have a Commander 3000 Control and this recall does not apply to you.

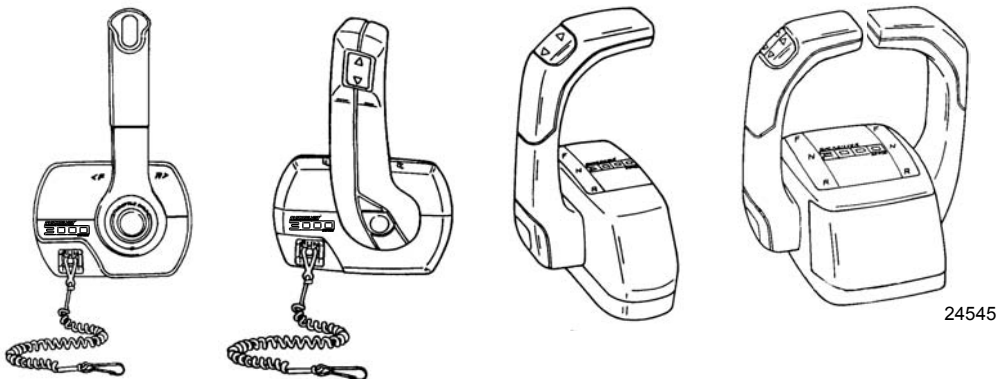

2. **Determine if you have a Commander 3000 control that is included in this recall.** View the decals on the control, if visually accessible, in the location shown below. Use a flashlight and mirror to help read the decals.

IMPORTANT: You are affected by this recall, and the control mechanism must be replaced, if it was built between June 1, 1994 and September 1, 1995 and does not have a "RKFV" decal on it.

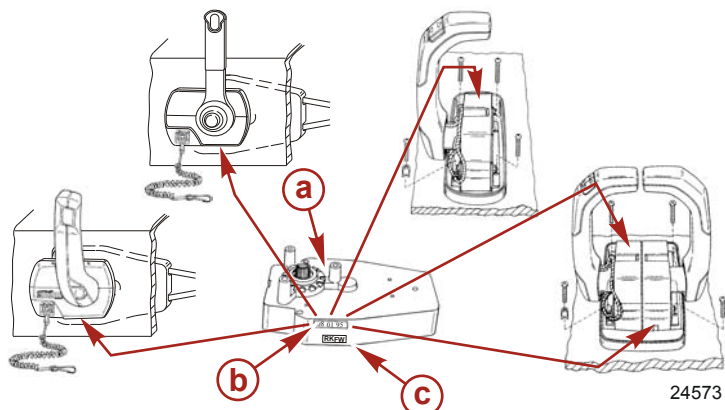

a - Control Mechanism
b - Build Date Decal

c - RKFV Decal

NOTE: The date may appear on the control in different forms: 08/01/95 (month/day/year) August 1, 1995. The month may also be written out in alpha characters as in the following: Aug/1/95 or 1/Aug/95. Decals may be placed in other locations.

Rework Identification

Commander 3000 remote controls built between June 1, 1994 and September 1, 1995 that have been reworked at the factory have a decal with the letters RKFV on the control. The affected gear has been replaced on these controls and the control is approved for use.

THE INFORMATION IN THIS DOCUMENT IS CONFIDENTIAL AND PROTECTED BY COPYRIGHT AND IS THE PROPERTY OF MERCURY MARINE.

This document is provided for the sole and exclusive use of the original recipient as prescribed by Mercury Marine and may not be distributed or copied, digitally or otherwise, without the prior written consent of Mercury Marine.

Owner Notification (US and Canada)

A combination letter/claim was sent to every registered owner of an engine on a boat built from June 1, 1994 and September 30, 1995 that may have used these Commander 3000 controls. The hull identification number (HIN) of these boats will end in the 4 digits F4XX through I5XX. The letter advised the owner to determine if their control is included in this recall, and to make an appointment with an authorized dealer to have affected controls inspected and replaced if necessary.

Dealer and Boat Builder Parts Stock

Inspect all Commander 3000 controls in parts stock. Return all controls with a build date on the mechanism between June 1, 1994 and September 1, 1995 that do not have the RKFV rework decal. Return all controls found with no build date. See **Commander 3000 Control Identification** for an explanation of the various dating methods used.

Boat Builders were asked to report the quantity and destination or registered owners of boats that may have been built with affected Commander 3000 controls, and engines from other manufacturers. Please fax the information to Commander 3000 Recall 1-920-924-1175

Boat Builder Boat Inventory

Inspect all boats in inventory that **may have** Commander 3000 controls built between June 1, 1994 and September 1, 1995. Replace and return all controls with a build date on the mechanism between June 1, 1994 and September 1, 1995 that do not have the RKFV decal. Return all controls found with no build date. Commander 3000 controls may have been installed on boats built with engines from other manufacturers. These controls also require inspection.

Dealer Boat Inventory

Inspect Commander 3000 controls on unsold boats in inventory. Commander 3000 controls are most likely to appear on boats with HIN numbers ending in F4XX through I5XX. Replace and return all controls with a build date on the mechanism between June 1, 1994 and September 1, 1995 that do not have the RKFV decal. Return all controls found with no build date. Commander 3000 controls may be used with engines from other manufacturers.

Dealer Sales of Commander 3000 Controls

Dealers are asked to contact purchasers of Commander 3000 controls, if possible, to bring their boat in for inspection. Inspect, replace, and return all controls with a build date on the mechanism between June 1, 1994 and September 1, 1995 that do not have the RKFV decal. Return all controls found with no build date.

Correction

The mechanism of Commander 3000 remote controls built between June 1, 1994 and September 1, 1995 that do not have the RKFV decal, and those found with no build date must be replaced with a Gen II Remote Control and Gen II Cables as described in tables below. The Gen II Remote Control must be used with Gen II Cables for this replacement as the Gen I Commander 3000 Remote Controls are no longer available (NLA).

Install per the instructions enclosed with the mechanism.

Readjust the throttle and shift cables per the applicable service manual.

THE INFORMATION IN THIS DOCUMENT IS CONFIDENTIAL AND PROTECTED BY COPYRIGHT AND IS THE PROPERTY OF MERCURY MARINE.

This document is provided for the sole and exclusive use of the original recipient as prescribed by Mercury Marine and may not be distributed or copied, digitally or otherwise, without the prior written consent of Mercury Marine.

Parts Required

Order for panel mount controls:

Remote Control	Required Cables
883710A01 - 4000 Panel Lock Bar Gen II Non Trim	Two (2) Premium GEN II Throttle/Shift Cables - 897978A__ (A03 through A50)
883710A02 - 4000 Panel Lock Bar Gen II OB Trim	Two (2) Premium GEN II Throttle/Shift Cables - 897978A__ (A03 through A50)
883710A03 - 4000 Panel Lock Bar Gen II MCM Trim	Two (2) Premium GEN II Throttle/Shift Cables - 897978A__ (A03 through A50)

Order for console mount controls:

Remote Control	Required Cables
883711A11 - 4500 Single Console No Trim	Two (2) Premium GEN II Throttle/Shift Cables - 897978A__ (A03 through A50)
883711A12 - 4500 Single Console OB Trim	Two (2) Premium GEN II Throttle/Shift Cables - 897978A__ (A03 through A50)
883711A13/14 - 4500 Single Console MCM Trim	Two (2) Premium GEN II Throttle/Shift Cables - 897978A__ (A03 through A50)
883711A01 - 4500 Dual Console No Trim	Four (4) Premium GEN II Throttle/Shift Cables - 897978A__ (A03 through A50)
883711A02 - 4500 Dual Console OB Trim	Four (4) Premium GEN II Throttle/Shift Cables - 897978A__ (A03 through A50)
883711A03/04 - 4500 Dual Console MCM Trim	Four (4) Premium GEN II Throttle/Shift Cables - 897978A__ (A03 through A50)

Warranty

Complete a warranty claim listing:

- Engine serial number if the control is in a boat or part number of controls from stock
- Quantity () 852430A 1 Panel Mount Mechanism **or**
- Quantity () 852430A 2 Console Mount Mechanism **or**
- Quantity () and part number of controls from stock
- Include the Quantity () and part number of the Gen II throttle cable and shift cable used.
- One-half hour (0.5) labor to inspect controls in boats
- One and three tenths hour (1.3) labor to inspect and replace controls in boats
- One hour (1.0) labor to replace throttle and shift cables with Gen II cables
- One quarter hour (0.25) labor to inspect and return controls from stock
- Labor Rate Code: OR19 for inspection only or OR20 for inspection and replacement
- Part Code: 318
- Failure Code: 40

USA AND CANADA

Complete/process the claim via MercNET or return a warranty claim form.

THE INFORMATION IN THIS DOCUMENT IS CONFIDENTIAL AND PROTECTED BY COPYRIGHT AND IS THE PROPERTY OF MERCURY MARINE.

This document is provided for the sole and exclusive use of the original recipient as prescribed by Mercury Marine and may not be distributed or copied, digitally or otherwise, without the prior written consent of Mercury Marine.

INTERNATIONAL

Follow instructions issued by Marine Power International office or by an authorized Marine Power Distributor.

THE INFORMATION IN THIS DOCUMENT IS CONFIDENTIAL AND PROTECTED BY COPYRIGHT AND IS THE PROPERTY OF MERCURY MARINE.

This document is provided for the sole and exclusive use of the original recipient as prescribed by Mercury Marine and may not be distributed or copied, digitally or otherwise, without the prior written consent of Mercury Marine.