

Circulate to: Sales Manager Accounting Service Manager Technician Parts Manager

Dressed Powerheads (3.0 Liter OptiMax)

Models Affected

Models Covered	Serial Number Or Year
3.0 Liter OptiMax 200/225 HP	2001/2002 model year S/N 0T178500 through 0T598999

Situation

There are a number of cases where a newer style (2003 & newer) dressed powerhead was installed on 2001 and 2002 model year 3.0 Liter OptiMax engines.

The newer powerhead assemblies have a number of parts that are different and are not compatible with the original powerhead parts. If parts are ordered using the engine S/N they may not fit or be compatible if a newer dressed powerhead had been installed. Prior to ordering powerhead parts for the above listed engines, identify which model year powerhead is on the engine.

THE INFORMATION IN THIS DOCUMENT IS CONFIDENTIAL AND PROTECTED BY COPYRIGHT AND IS THE PROPERTY OF MERCURY MARINE.

This document is provided for the sole and exclusive use of the original recipient as prescribed by Mercury Marine and may not be distributed or copied, digitally or otherwise, without the prior written consent of Mercury Marine.

Dressed Powerhead Identification

The original 2001 and 2002 dressed powerheads used a one piece air regulator on the port fuel rail. The 2003 and newer models use a multi-piece regulator.

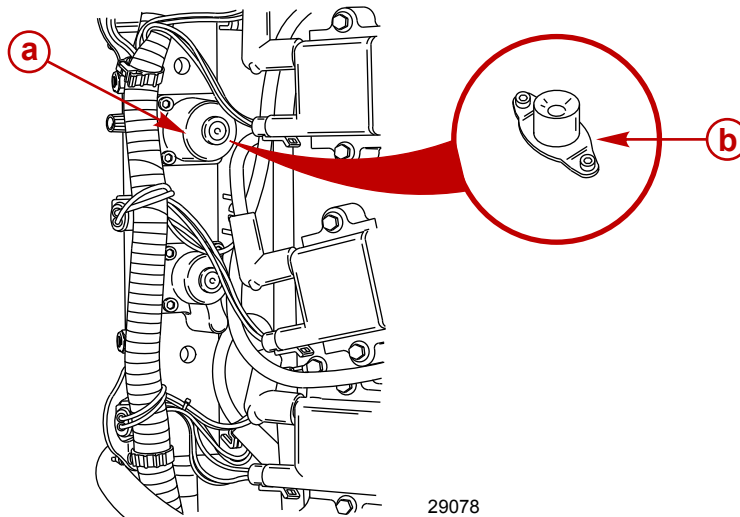

Air pressure regulator location on port fuel air

- a** - Multi piece air regulator on port fuel rail 2003 and newer
- b** - One piece air regulator on 2001/2002 models

If a multi-piece regulator is found on the port rail, order replacement powerhead parts from the 2003 parts list.

NOTE: *Most of the newer style powerheads were replaced under warranty and are recorded in engine serial number history. After inspection of the port rail air regulator, if there are still questions whether the powerhead has been replaced with a newer style, contact Outboard Technical Service.*

- US Outboard Technical Service (920) 929-5884
- Canada Technical Service (905) 816-4751
- International contact Marine Power International or an authorized Marine Power Distributor

THE INFORMATION IN THIS DOCUMENT IS CONFIDENTIAL AND PROTECTED BY COPYRIGHT AND IS THE PROPERTY OF MERCURY MARINE.

This document is provided for the sole and exclusive use of the original recipient as prescribed by Mercury Marine and may not be distributed or copied, digitally or otherwise, without the prior written consent of Mercury Marine.