

Circulate to: Sales Manager Accounting Service Manager Technician Parts Manager

1.5L OptiMax Compressor Temperature Sensor Torque Change Models Affected

Models Covered
Mercury/Mariner All 75–125 HP 1.5L OptiMax Engines

Situation

To prevent under cowl water leakage, the temperature sensor mounted on the air compressor cylinder head has a new torque. See the torque specifications following. Please use this new torque value when servicing the 1.5L OptiMax compressor. This information will be included in the next revision of the service manual.

Description	Nm	lb-in.	lb-ft
Temperature sensor	13.6–20.3		10–15

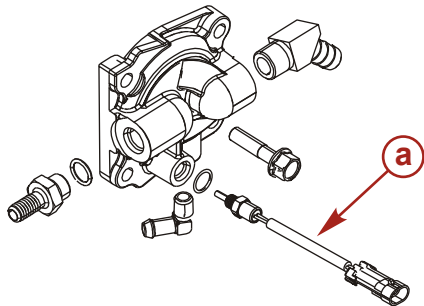

a - Temperature sensor

This change was implemented with starting S/N 1B775632.

THE INFORMATION IN THIS DOCUMENT IS CONFIDENTIAL AND PROTECTED BY COPYRIGHT AND IS THE PROPERTY OF MERCURY MARINE.

This document is provided for the sole and exclusive use of the original recipient as prescribed by Mercury Marine and may not be distributed or copied, digitally or otherwise, without the prior written consent of Mercury Marine.