

TO: SERVICE MANAGER  TECHNICIANS   
PARTS MANAGER

No. 96-3

Revised January 1996

## Serpentine Belt Adjustment

### Models

MCM V6 Stern Drive Models.

### Tools Required

- (1) 5/8 in. Open End or Box Wrench.
- (1) 5/16 in. Deep Well Socket.

### Belt Adjustment

The upper, left idler pulley is the belt adjustment pulley.

1. Loosen 5/8 in. locking nut on adjustment stud. Leave wrench on adjustment stud.

**NOTE:** Belt deflection is to be measured on the belt at the location that has the longest distance between two (2) pulleys. Normally this location is between the power steering pump and the belt adjustment pulley. This location will be different on engine with closed cooling or models without power steering.

2. Use 5/16 in. socket and tighten adjusting stud until there is 1/4 in. (6 mm) deflection in the belt at location specified above.
3. While holding adjustment stud at the correct belt tension, tighten 5/8 in. locking nut.
4. Run engine for a short period of time and recheck belt adjustment.

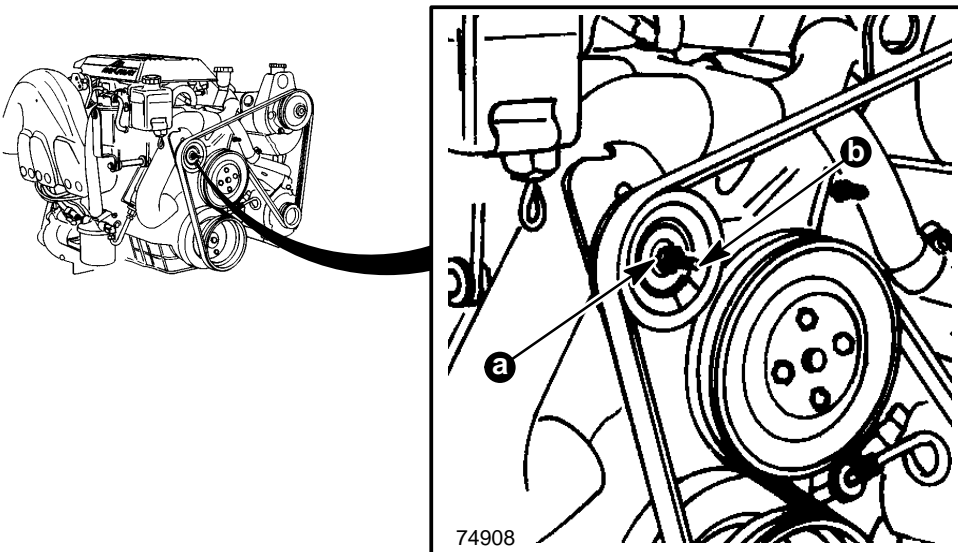

a - 5/8 in. Locking Nut.  
b - Adjusting Stud.