

TO: SERVICE MANAGER  MECHANICS   
PARTS MANAGER

91-22

## A. ALPHA ONE VERSUS ALPHA ONE GENERATION II UPPER DRIVE SHAFT

### Models

All Alpha One and Alpha One Generation II drive units.

### Problem

The upper drive shaft for an Alpha One looks very much like the one used on the Alpha One Generation II. The only difference between the two shafts is the Generation II has an oil hole through the center of the shaft. Also when pressed on to the gear it does not use an O-ring between the shaft and the gear. The upper drive shaft used on the Alpha One is solid and uses the O-ring between the gear and the shaft to prevent oil leakage.

The reason for the hole in the shaft used on the Generation II is to get the oil down to the drive shaft splines to lubricate them. If the Generation II shaft is used on the Alpha One (1990 and prior) the oil would leak out of the upper housing past the splines and cause gear or bearing failure.

### Parts

When using parts from your stock or when ordering from MerCruiser parts book order P/N 45-55796 for Alpha One S/N 0D494568 and below, for Alpha One Generation II order P/N 45-55796--1 for S/N 0D494569 and above.



**Upper Drive Shaft  
Alpha One**

71214

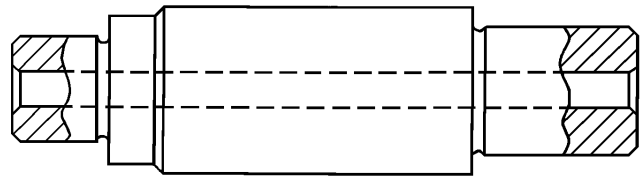

**Upper Drive Shaft  
Alpha One Generation II**

71213