

Gimbal Housing Oil Reservoir Bulkhead Fitting - Material Change

Models

Alpha One / Bravo One / Two / Three and BlackHawk

Description

The oil reservoir bulkhead fitting in the gimbal housing will change from a brass material to a glass filled composite material. This change will incorporate a (90 degree) quick connect fitting and will connect the same way as the speedometer connection for the Alpha drive does at the bell housing.

The following table indicates the serial number ranges and shows the type of fitting used at the start up the 1998 transom production.

Serial Numbers	Fitting Material	Housing Casting Number
0L259073 thru 0L261320	Composite	43880C11
0L261321 thru 0L261399	Brass	43880C10
0L261400 thru 0L266720	Composite	43880C11
0L266721 thru 0L266780	Brass	43880C10
0L266781 and Above	Composite	43880C11

The service replacement gimbal housing, part number 43881A14 will supersede all Alpha One gimbal housings and 43881A15 will supersede all Bravo gimbal housings.

As an example the older 43881A8 non oil reservoir type gimbal housing for the Alpha One has been superseded to a 43881A14 housing and will come with a solid plugged bulkhead fitting for use with the non oil reservoir type units.

This change will assist in the ease of the oil hose connection during installation by eliminating the need for the use of a wrench to attach and tighten the brass connector fitting. The composite fitting assembly **will not** back fit into the Alpha and Bravo Transom assemblies that have the brass fitting, because of a machining change to the gimbal housing for the new fitting.

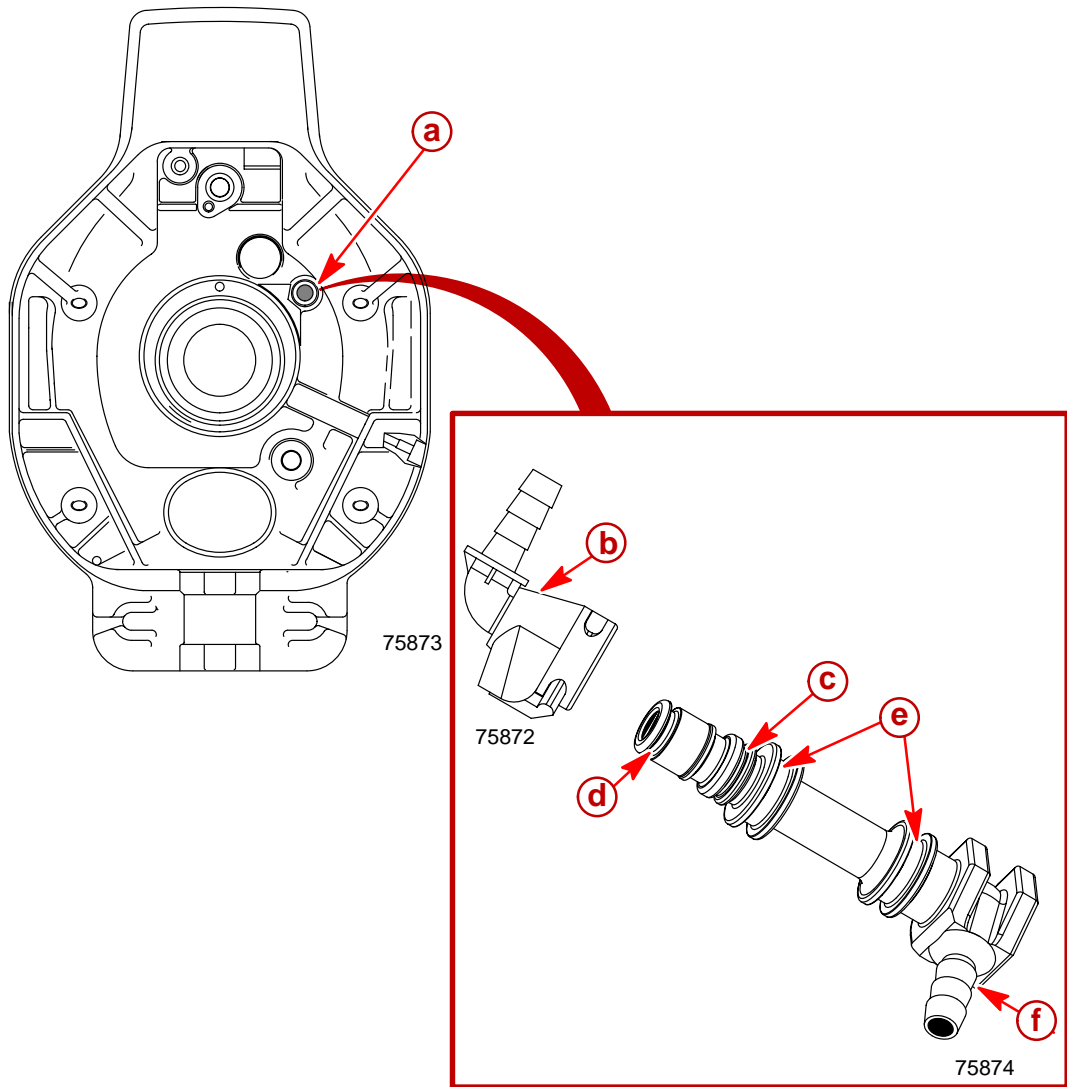

▲43881A14 Gimbal Housing

- a** - Bulkhead Fitting Location
- b** - Quick Connect Fitting (22-861163)
- c** - "E" Ring Groove (53-87843)
- d** - "O" Ring Groove (25-62702)
- e** - "O" Ring Groove (25-20195)
- f** - Bulkhead Fitting (22-861150A1)▲