

Circulate to:  Sales Manager  Accounting  Service Manager  Technician  Parts Manager

## Removing a GPS Unit from Its Pedestal

### Scope

Worldwide.

### Models Affected

All Axis Premier packages.

### Situation

Removing a GPS unit from the pedestal requires special care to prevent twisting of the CAN H NMEA 2K harness.

1. Remove the three screws from the base of the GPS unit.  
**IMPORTANT: Do not twist the base of the GPS from the pedestal.**
2. Gently pull the GPS unit up from the base and support the GPS unit while turning the CAN H NMEA 2K harness connector counterclockwise.
3. Loosen and remove the CAN H NMEA 2K harness .  
**IMPORTANT: The threaded connector must be completely loose before removal to avoid damage to the cable or GPS unit.**

### Installation

When installing, make sure the CAN H NMEA 2K harness does not twist in the supporting tube. If the base was removed, install the base to the standard marine mount pole before attaching the CAN H NMEA 2K cable and base to the GPS.

1. Support the GPS unit while connecting the cable.
2. Align the keyway of the CAN H NMEA 2K harness connector to the GPS unit connector and tighten securely.

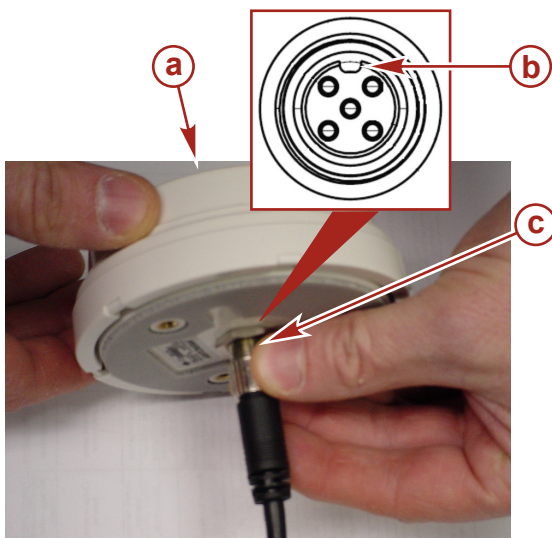

46309

3. Make sure the base is secured to the pedestal.

THE INFORMATION IN THIS DOCUMENT IS CONFIDENTIAL AND PROTECTED BY COPYRIGHT AND IS THE PROPERTY OF MERCURY MARINE.

This document is provided for the sole and exclusive use of the original recipient as prescribed by Mercury Marine and may not be distributed or copied, digitally or otherwise, without the prior written consent of Mercury Marine.

## Removing a GPS Unit from Its Pedestal

---

4. Place the GPS unit on the base and install the 3 screws. Tighten.

THE INFORMATION IN THIS DOCUMENT IS CONFIDENTIAL AND PROTECTED BY COPYRIGHT AND IS THE PROPERTY OF MERCURY MARINE.

This document is provided for the sole and exclusive use of the original recipient as prescribed by Mercury Marine and may not be distributed or copied, digitally or otherwise, without the prior written consent of Mercury Marine.