

WARRANTY INFORMATION SERVICE INFORMATION

Fuel Pressure Dampener Modification

Models Affected:

All HP 500 EFI engines, serial number 0L415920 & **below**

Problem

The fuel in the fuel rail develops a pulse at certain RPM's that the fuel pressure dampener cannot control. This causes a lean condition and backfiring.

Installation of Kit 22-841435A1

1. Cut off the vent hose for the fuel pressure regulator just below the barb (approx. 1" [25mm]) of the 90° fitting on the back of the intake plenum. Remove the 90° fitting.

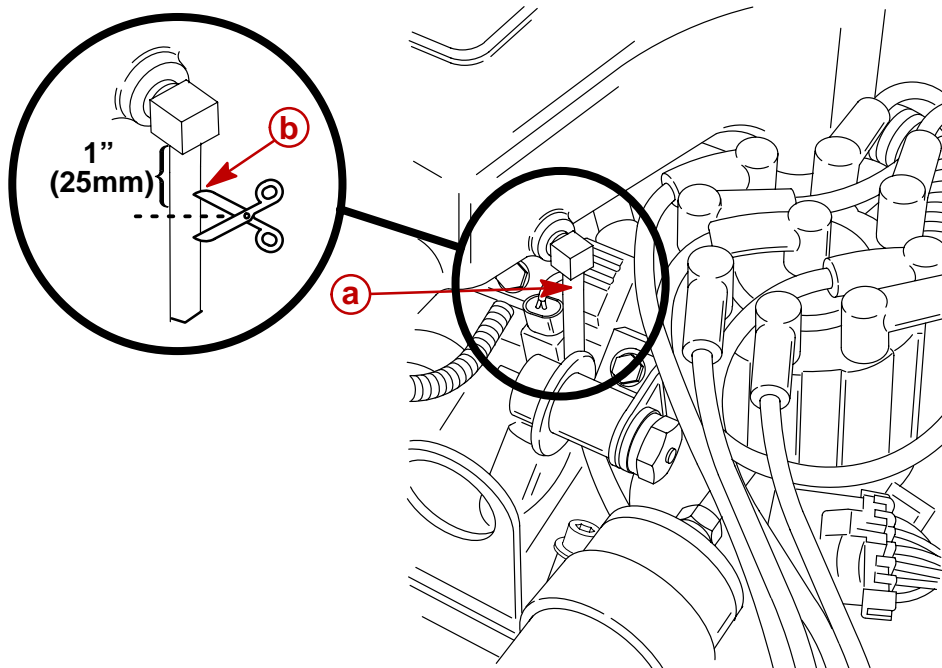

- a** - Hose to 90° Fitting
b - Cut Off Hose Just Below Barb

2. Install the double barbed fitting from the kit. Rotate fitting clockwise 30 to 45° from vertical for easy routing of hoses (see illustration).
3. Remove the rubber nipple from the end of the pressure dampener.

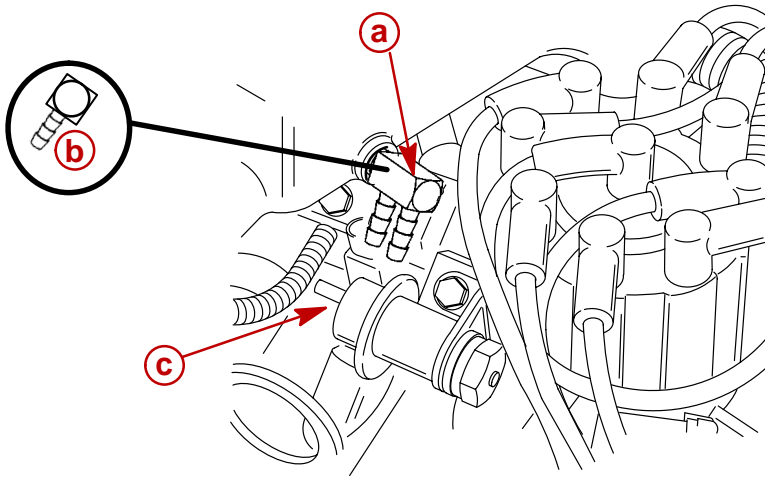

- a - Double Barbed Fitting From Kit.
- b - Install double Barbed fitting 30 to 45° clockwise from vertical.
- c - Rubber Nipple On Pressure Dampener

4. Install hose from kit (do not shorten hose) between the dampener and double barbed fitting [a]

NOTE: Hose should be connected to outlet on fitting closest to intake plenum as shown below [b]).

5. Attach hose removed from original 90° fitting to the other connection on the double barbed fitting.

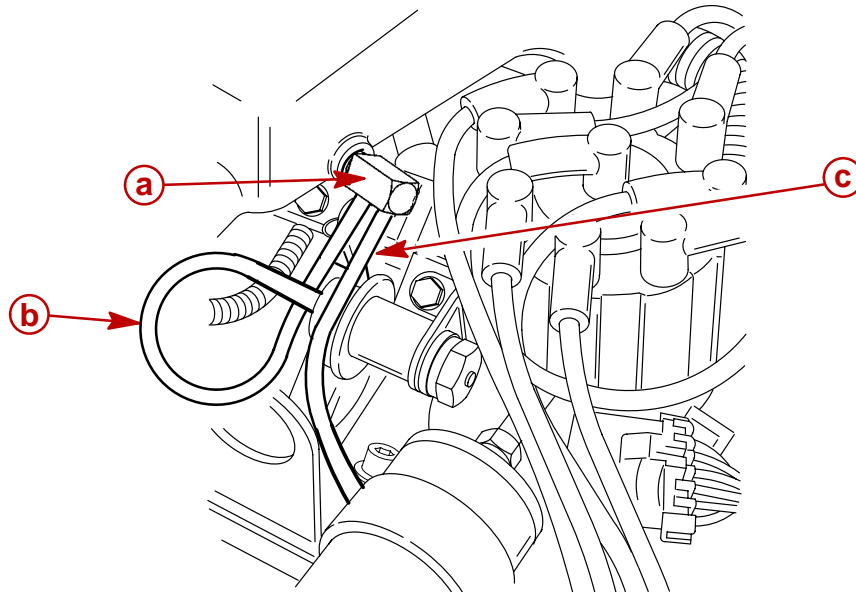

- a - 90° Double Barbed Fitting
- b - Hose From Kit - Install Between Fuel Pressure Dampener and 90° Double Barbed Fitting
- c - Original Hose from 90° Single Fitting

Warranty Information

Fill out a warranty claim and send it to your normal warranty processing center. More than one engine can be put on the warranty claim if the following information for each engine is on separate lines on the warranty claim.

Serial Number	Engine Model	Part Number	Warranty Code	Labor Hours
---------------	--------------	-------------	---------------	-------------

Warranty Code: **None**

Labor: **0.5 hrs.**