



parts bulletin



No. 98-2

Steering Attachment Bolt 10-849838

Models Affected

All Mercury and Mariner Hi-Performance Outboards:
Pro Max/Super Magnum 150/200/225/& 300
All 2.5 EFI Models

Beginning on January 2, 1998 all Hi-Performance model outboards have been shipped with a new steering attachment bolt, 10-849838, which attaches the steering link rod to the steering tiller arm.

When servicing steering components on Hi-Performance outboards built before January of 1998, the steering attachment bolt should be replaced with the new bolt.

BOLT IDENTIFICATION

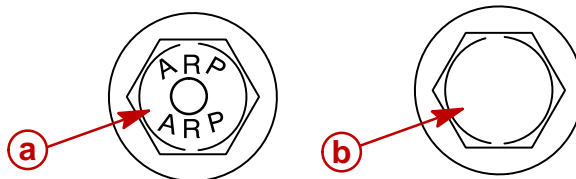

- a** - Recommended Bolt (10-849838) for All Hi-Performance Engines Has Vendor Letters (ARP) on Head
- b** - Bolt Used Before January, 1998 Has No Letters.

CAUTION

STEERING ATTACHMENT COMPONENTS USED ON HI-PERFORMANCE OUTBOARDS SHOULD BE VISUALLY INSPECTED FOR WEAR, LUBRICATED AND ALL ATTACHMENT HARDWARE CHECKED FOR PROPER TORQUE TIGHTNESS EVERY 25 HRS. OF OPERATION.

1. An access hole is provided thru the bottom cowl to ease installation of the link rod connecting bolt. Reinstall plug after completion.
2. Install steering link rod per illustration.

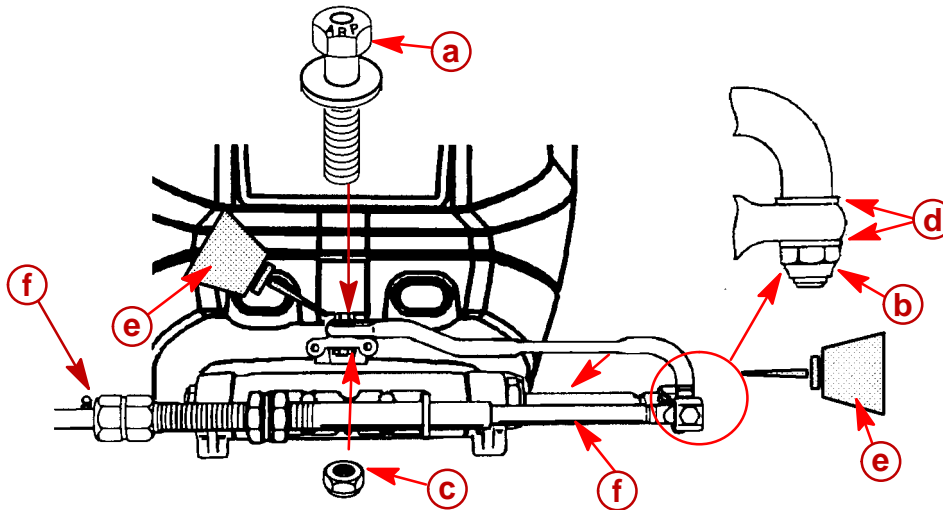

- a** - Special Bolt (10-849838) - Tighten to 20 lb. ft. (27 N·m)
- b** - Nylon Insert Locknut (11-34863) -Tighten Until Nut Seats Then Back Off 1/4 Turn
- c** - Nylon Insert Locknut - Tighten to 20 lb. ft. (27 N·m) after Torquing (a)
- d** - Flat Washers
- e** - 30W Motor Oil
- f** - Lubricate with 2-4-C With Teflon (92-825407A12) or Special Lubricant 101 (92-13872A1)