

## POWER TRIM & TILT PUMP/MOTOR KIT FK654541

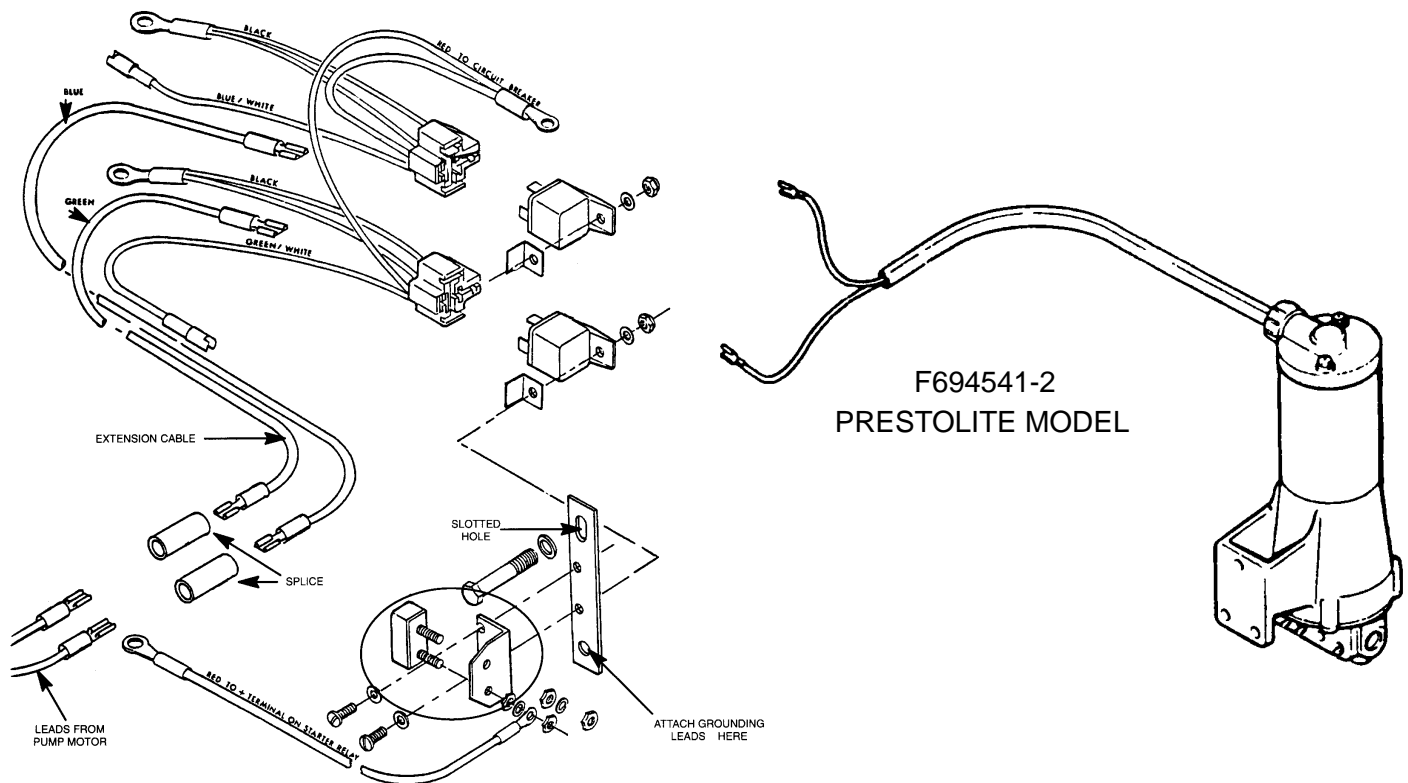

### MODEL

Chrysler Outboards (1971 Thru 1984) and Force Outboards (1984 Thru 1987) With Power Trim & Tilt. This kit superseded the following parts, (F17556 Field and Frame Assy) (F17563 Motor and Reservoir) (F17564 Valve Body) and (F17568 Pump and Valve Assy).

### CHANGE

When existing stock of FK654541 (Power Trim & Tilt Pump/Motor Kit ) is depleted order your replacement kit below.

- |          |   |                                     |
|----------|---|-------------------------------------|
| 853515A1 | <b>70 Thru 150 HP (3 or 4 Cylinder)</b> | <b>(Four Line Hydraulic System)</b> |
| 853674A1 | <b>35 Thru 65 HP (2 Cylinder)</b>       | <b>(Four Line Hydraulic System)</b> |